

About the Wood and Finish

This product has been carefully crafted of: MDF, solid pine wood and/or pine veneers. These materials derive from plantations, a renewable and well managed forest, therefore, not endangering the environment. The highest quality standards have been implemented to assure a sturdy and reliable product. Due to the natural variances in the

graining of wood, you may notice subtle differences in the shading and tone of the color stain, warp, holes, wood knots and also small cracks. This is not a defect.

But rather a result of the natural beauty of the wood itself.

Care and maintenance:

Dust when needed using a smooth, dry cloth. Household furniture polish can be used occasionally to restore luster.



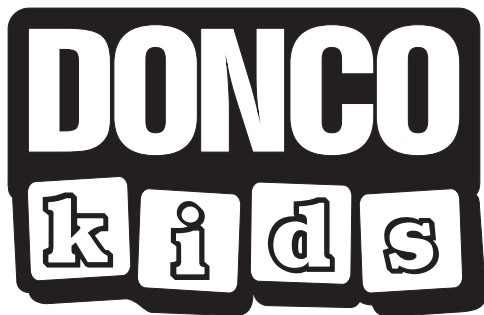

Fort Worth, Texas 76140

ASSEMBLY INSTRUCTIONS

5000 - 3 DRAWERS CHEST

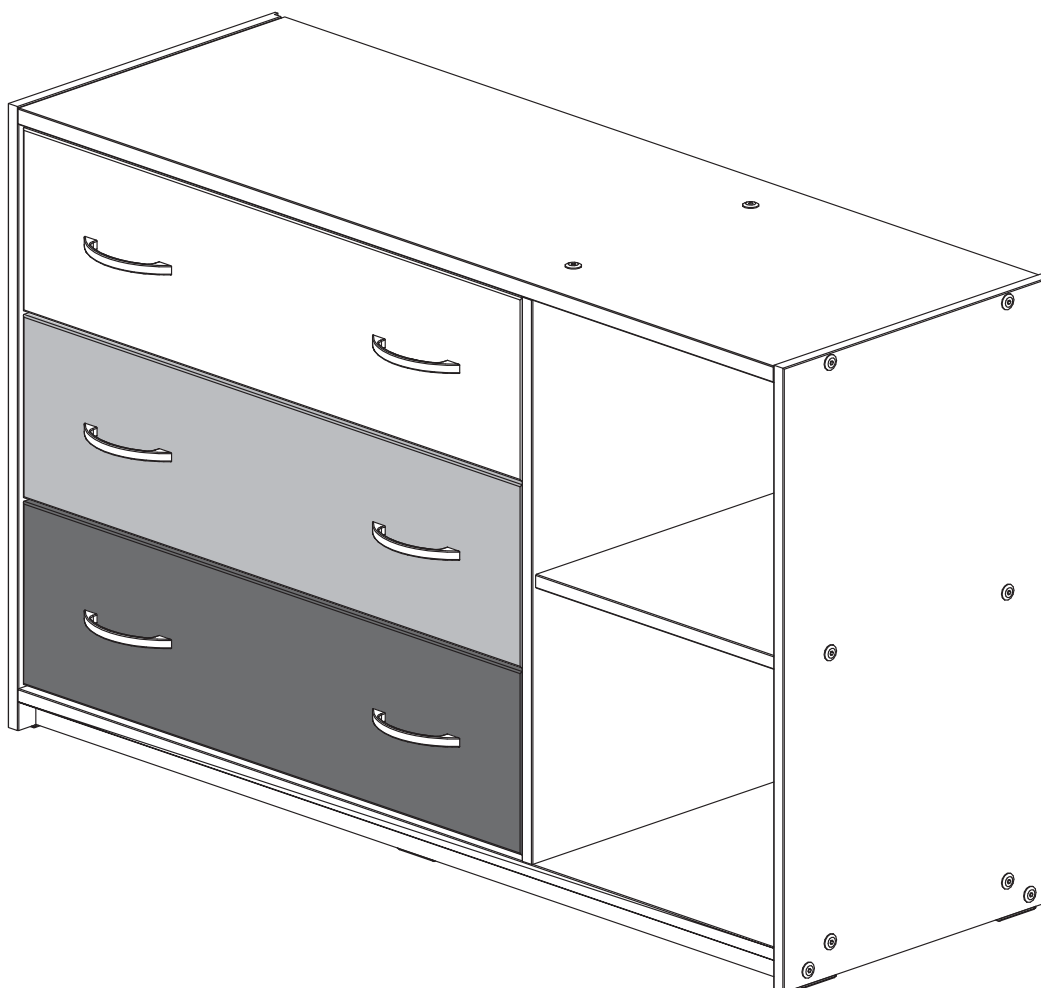

Thank you for purchasing this quality product. Be sure to check all packing material carefully for small parts which may have come loose inside the carton during shipment. Separate identify and count all parts and hardware.

Compare with the parts list to be sure all parts are present.

"DO NOT TIGHTEN SCREWS UNTIL COMPLETELY ASSEMBLED"

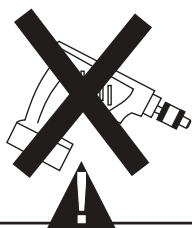

* Use of power tool to assemble this product will invalidate any claim and damage this product making unsafe !!!
* Please assemble on a clean soft surface to avoid damage.



+



Tools Required

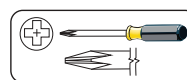

(Not included)

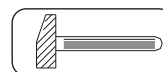



(Not included)

IMPORTANT:

PLEASE READ INSTRUCTION BEFORE STARTING THE ASSEMBLY

Part List - 5000 - 3 DRAWERS CHEST

 **WARNING LABEL**

 **MANUFACTURER LABEL**

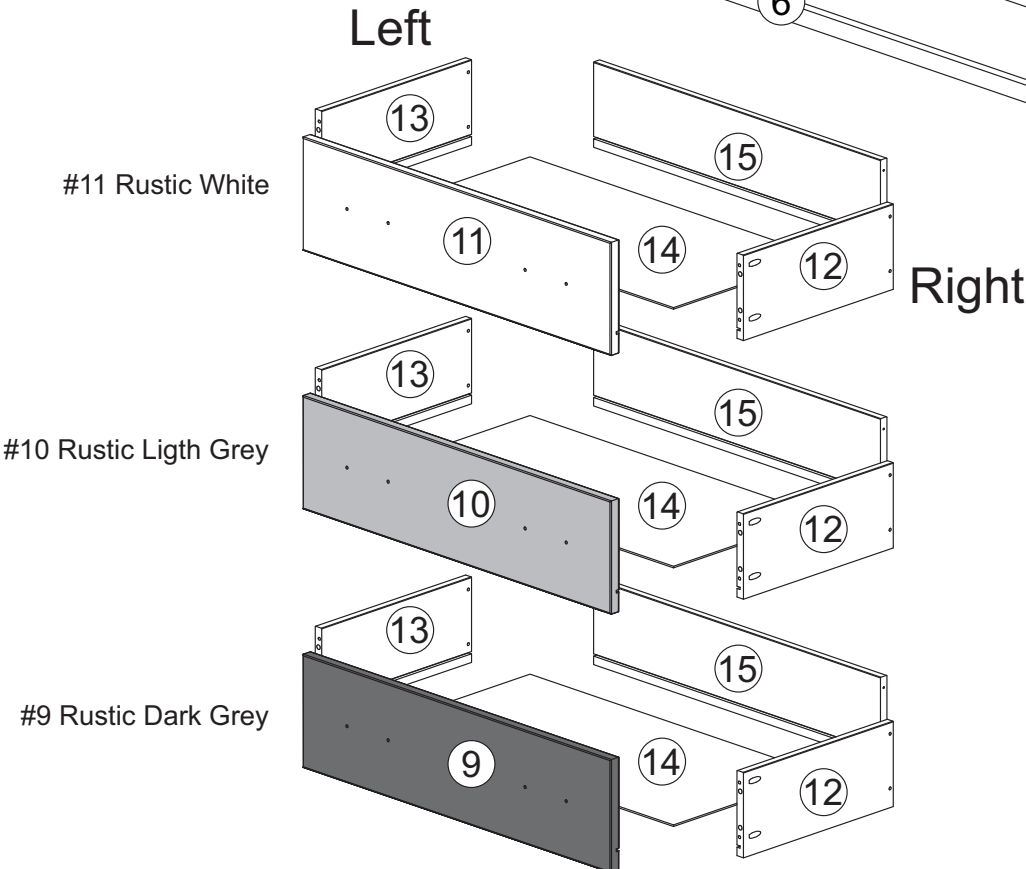
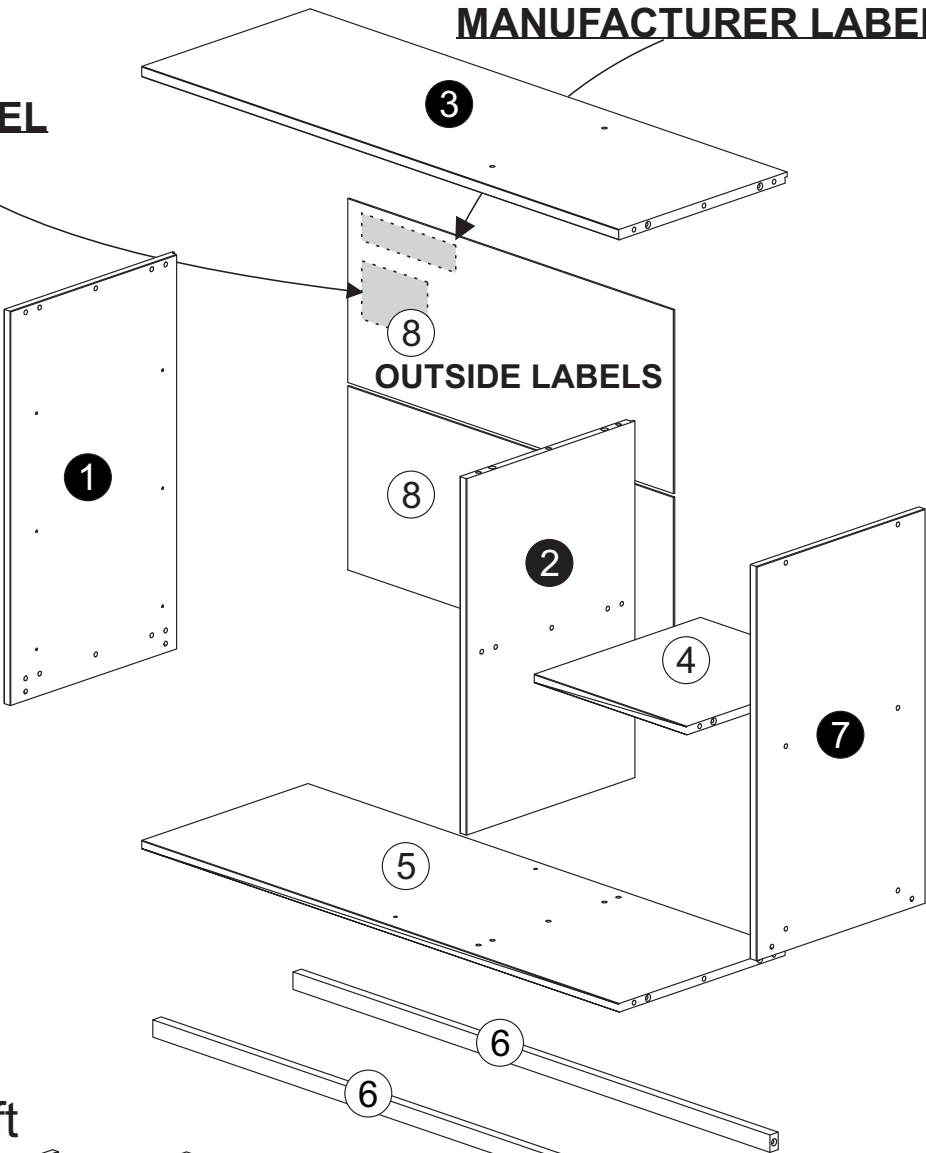

Identifying the Hardware-Identify the hardware using the illustrations below.

A

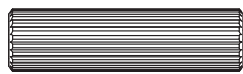

8 x 30 Wood Dowel

Qty
36

B

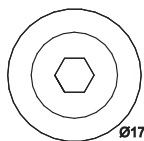

Ø17

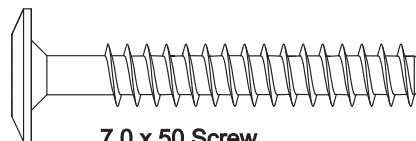

7,0 x 50 Screw

Qty
20

C

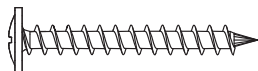

1 $\frac{3}{16}$ " Screw

Qty
26

D



$\frac{3}{8}$ " Screw

Qty
24

E

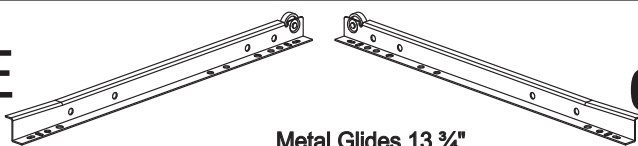

Metal Glides 13 $\frac{3}{4}$ "

Qty
03

F

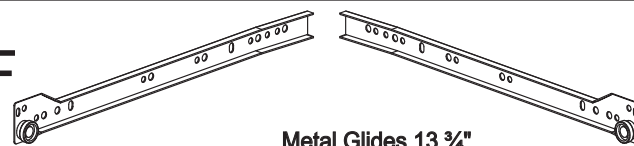

Metal Glides 13 $\frac{3}{4}$ "

Qty
03

G



M4,0 x 25 Screw

Qty
12

H



Knob

Qty
06

I

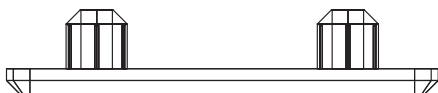

Plastic Foot

Qty
06

J



10 x 10

Qty
26

K

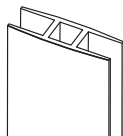

Qty
01

L

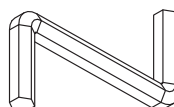

Hex
Screwdriver

Qty
01

01

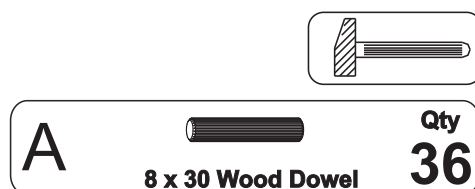
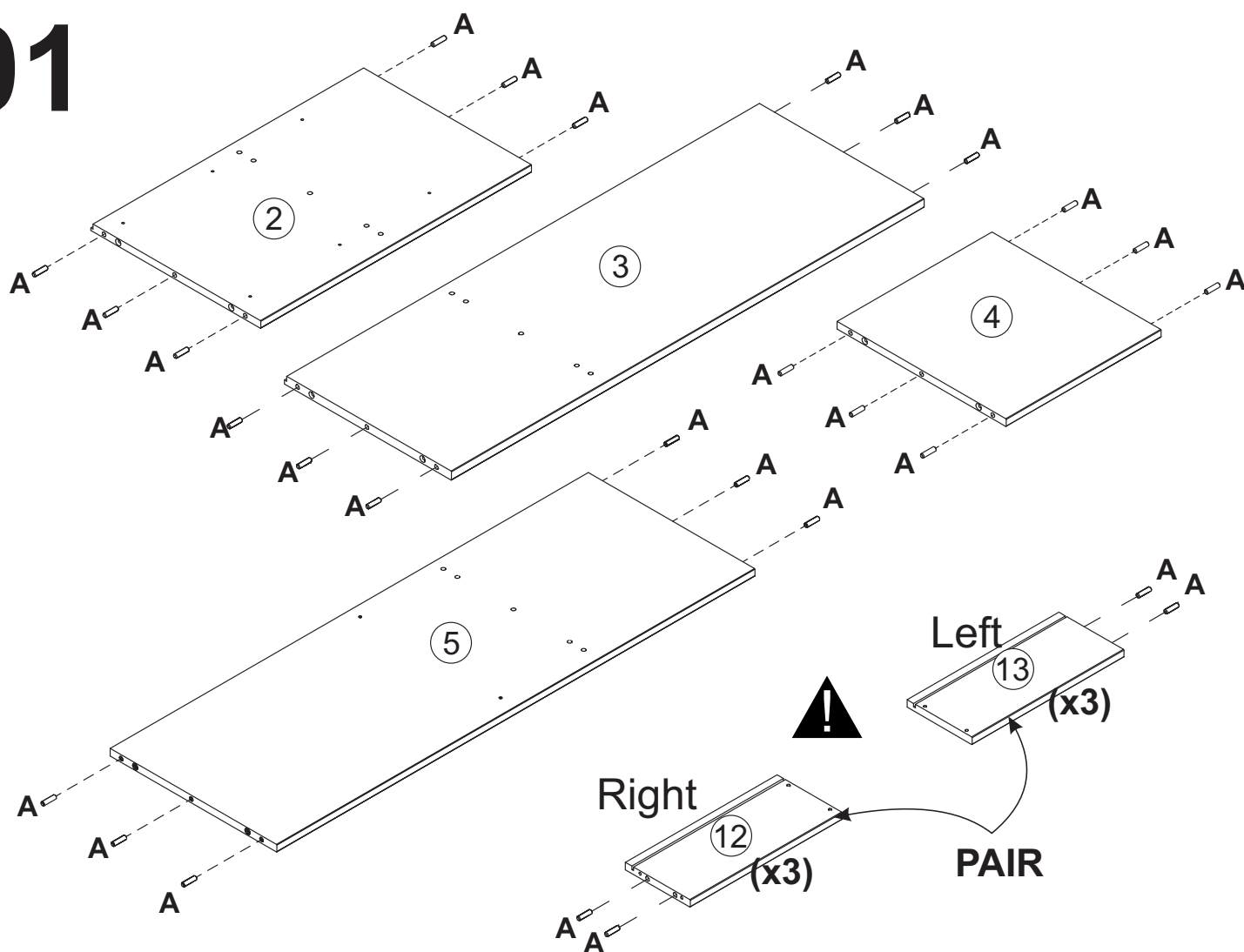

SET OF METAL GLIDES FOR THE DRAWERS

The metal glides hardware are all in one packed. Please separate the left and right pieces like a pair.

- The glides **#F** are used on chest panel side and has a left and middle pieces.
- The glides **#E** are used on drawers side, also has a left and right pieces.

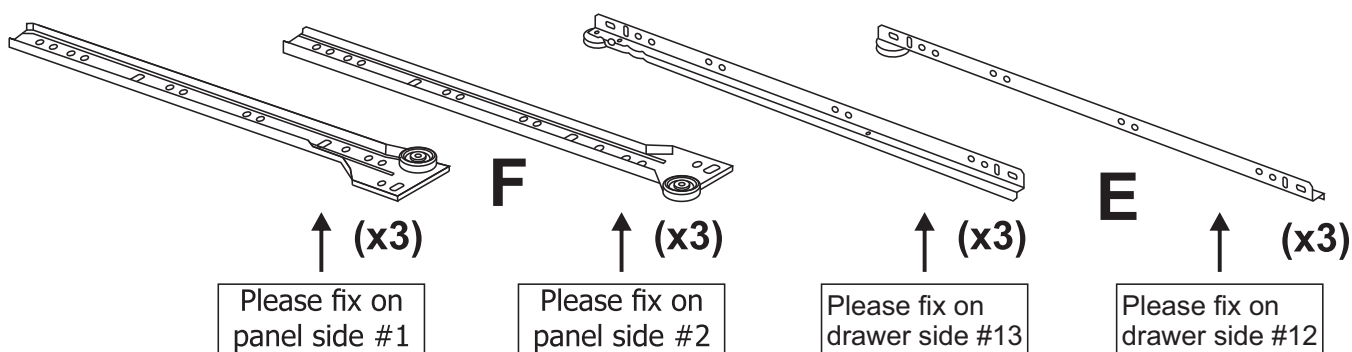



The wheel to the front!

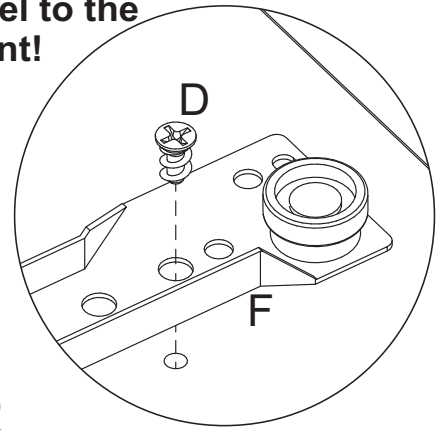

The wheel to the front!

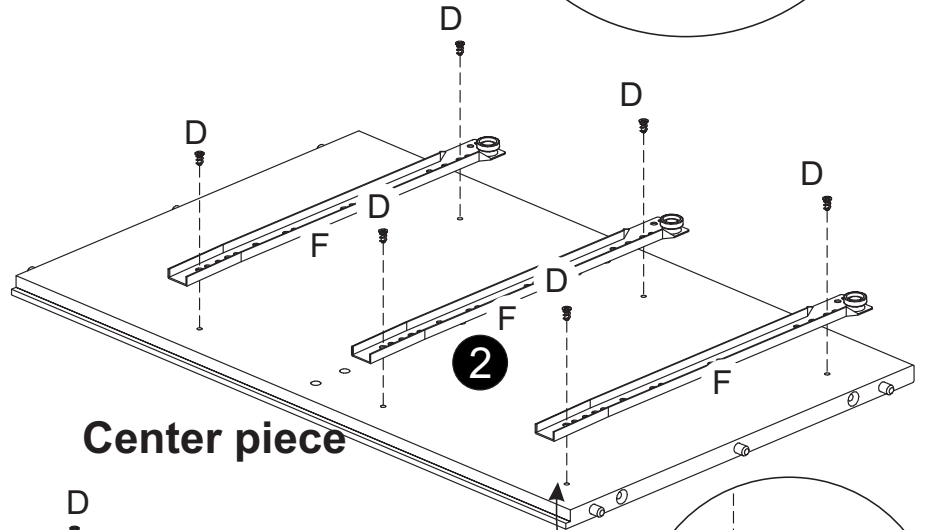
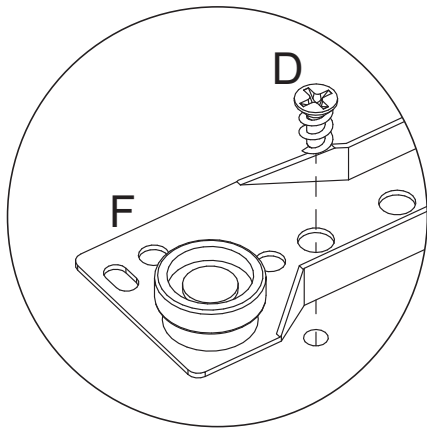

Center piece

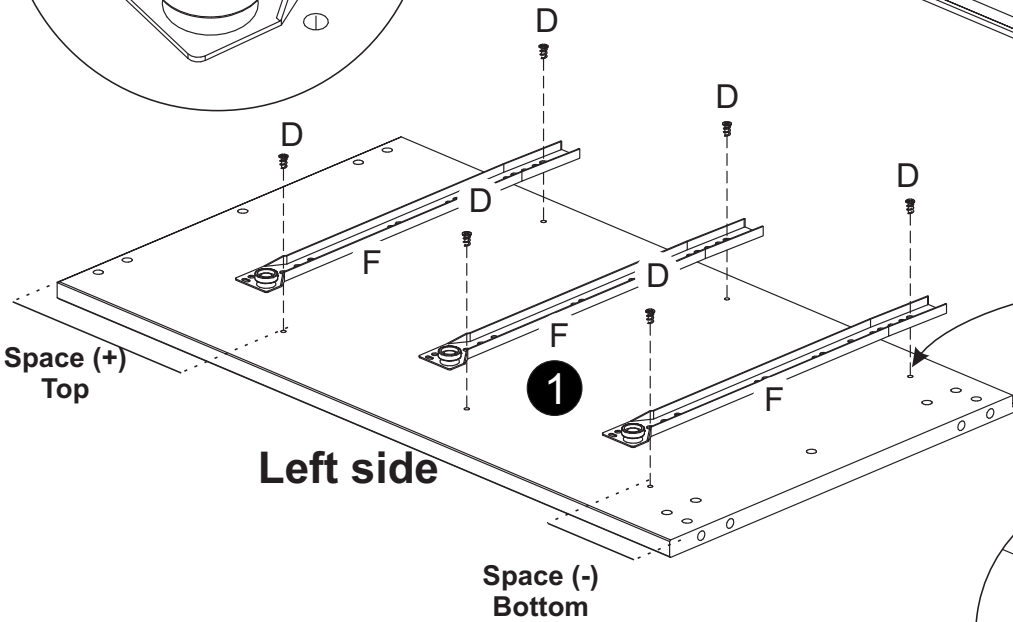

Left side

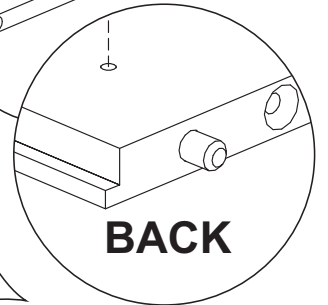

BACK

PRE DRILLED HOLES

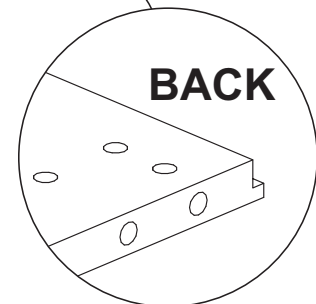

BACK

F **Metal Glides 13 3/4"** **Qty 03**

D **6,0 x 10 Screw** **Qty 12**

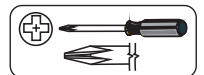

03

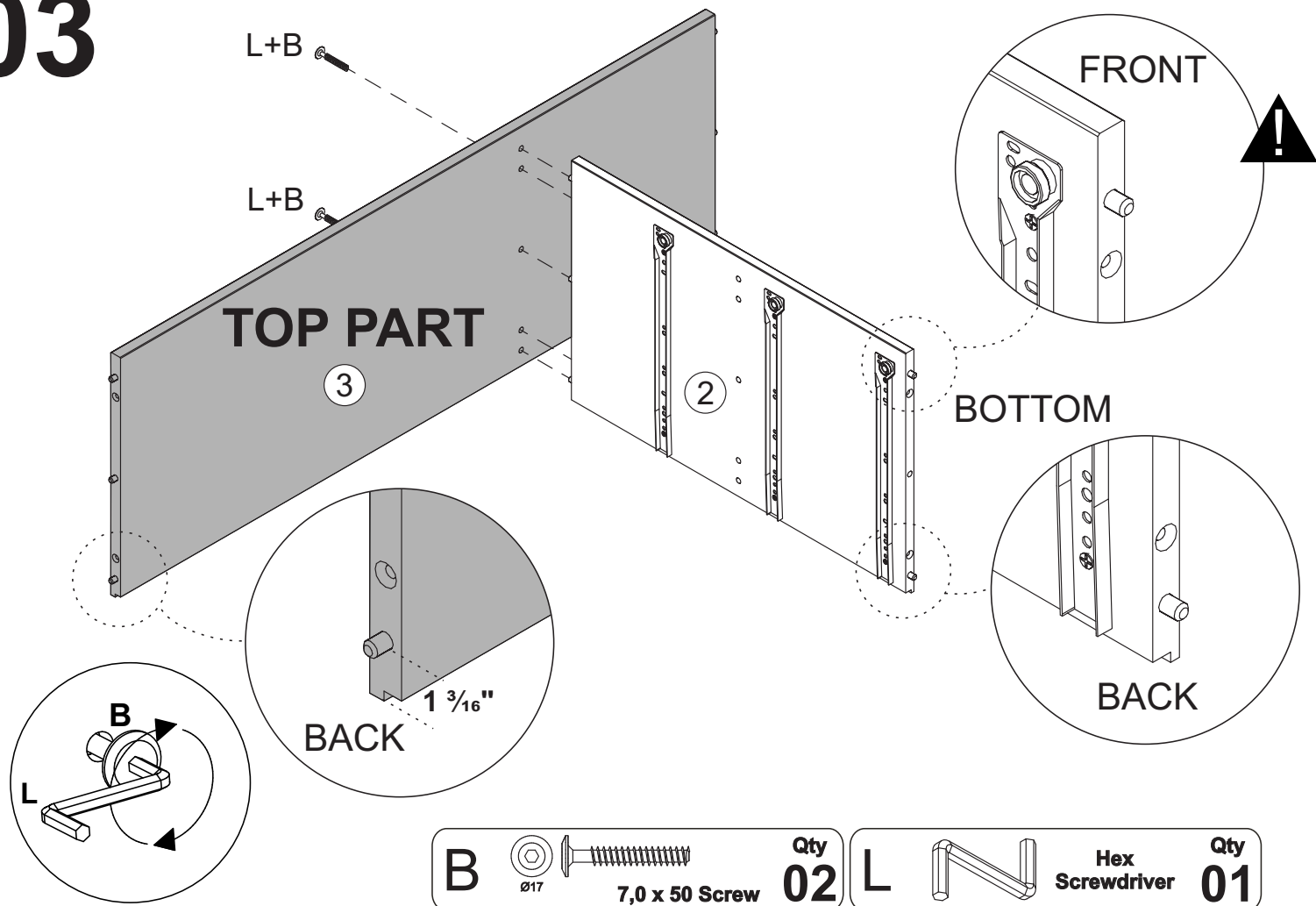

04

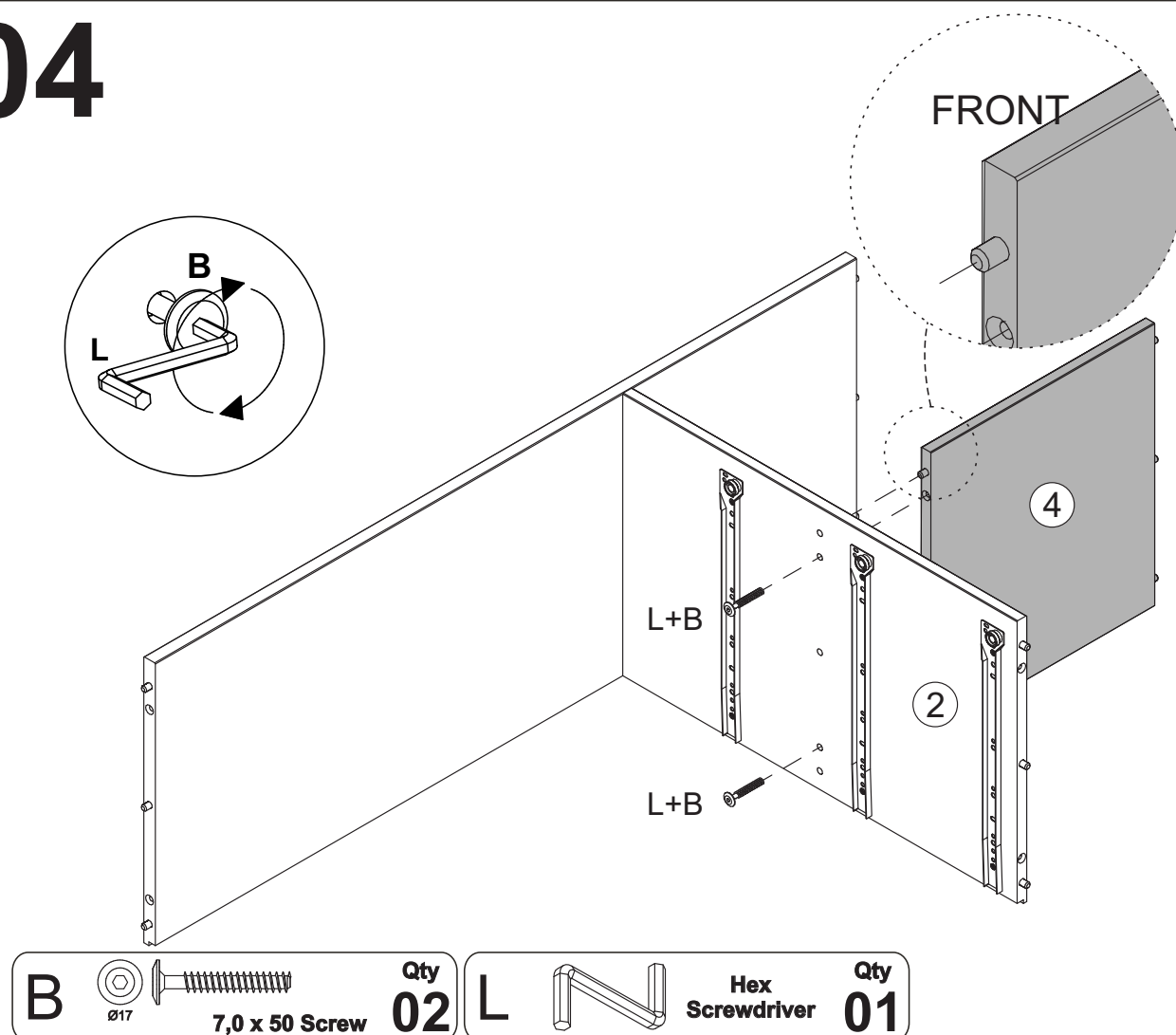

05

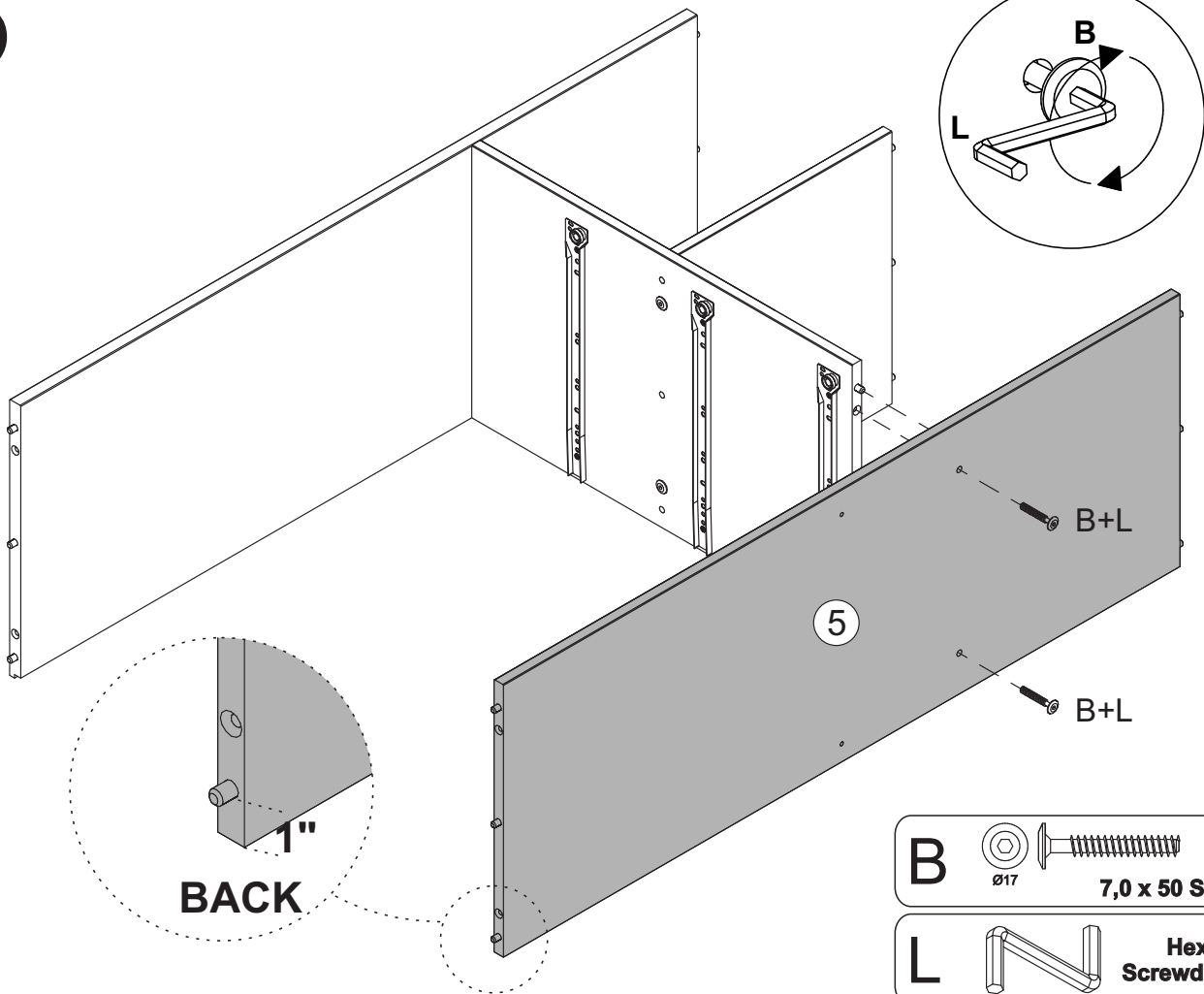

06

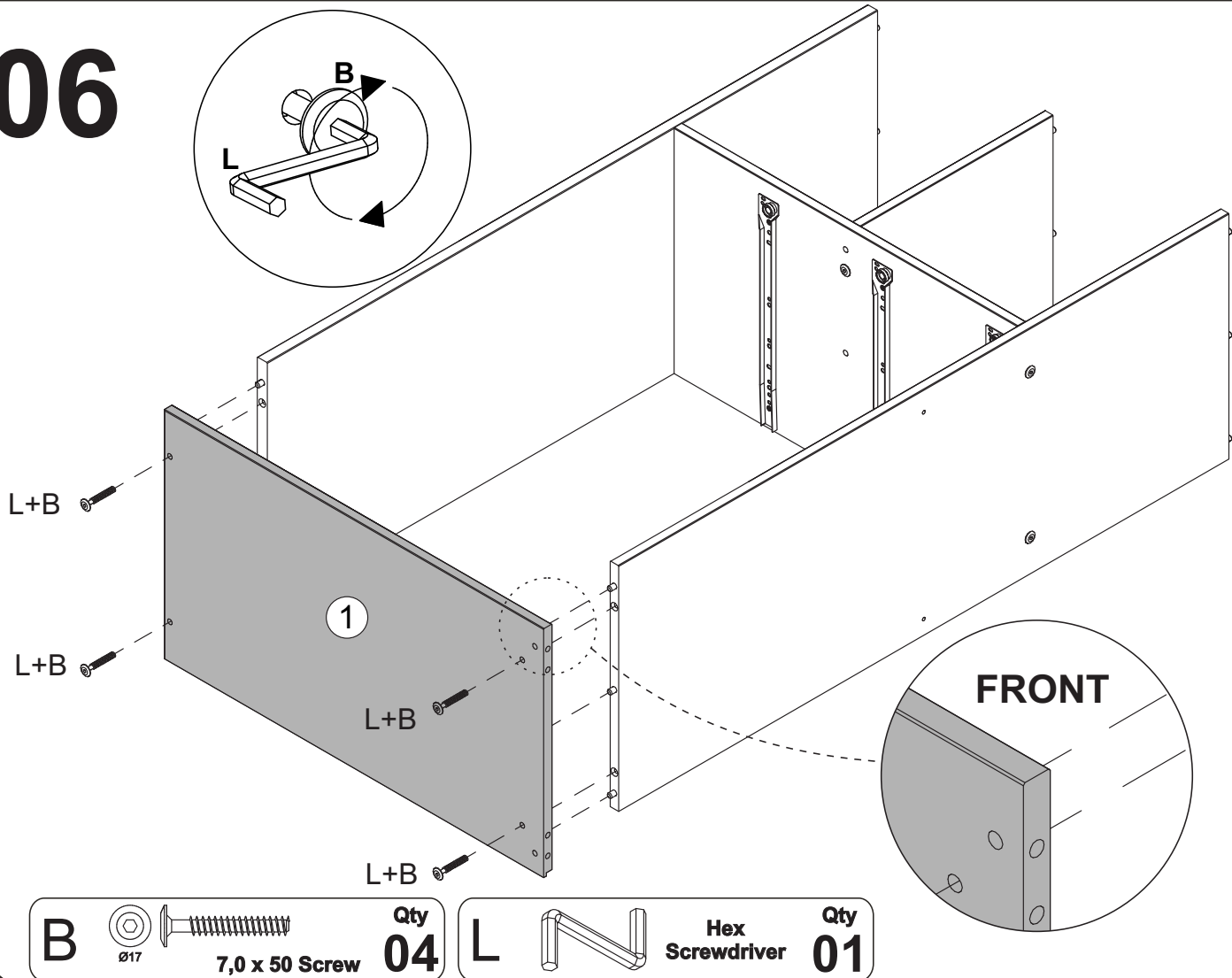

07

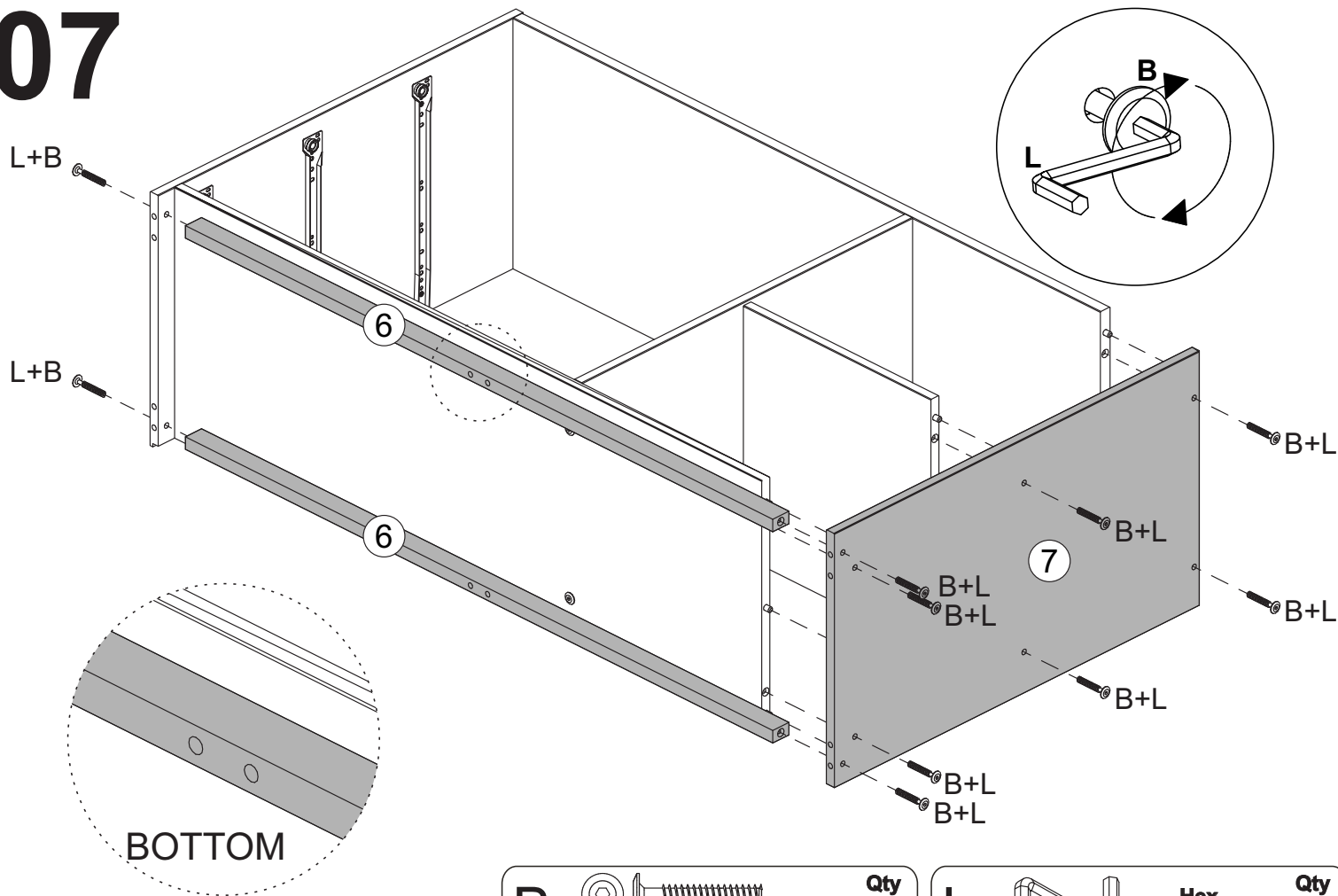

B  $\varnothing 17$ 7,0 x 50 Screw **Qty 10**

L  Hex Screwdriver **Qty 01**

08

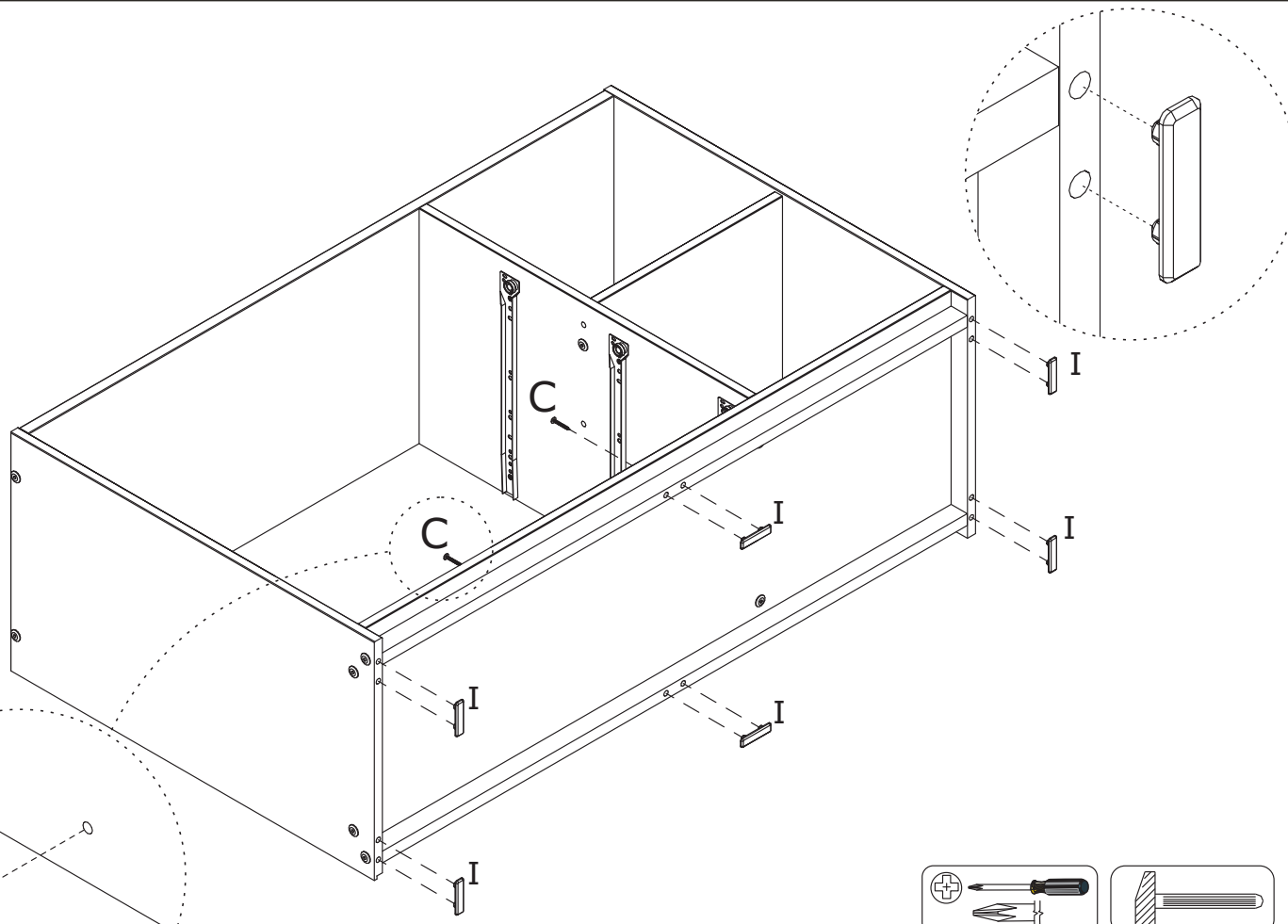

C  4,0 x 30 Screw **Qty 02**

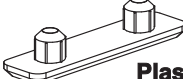
I  Plastic Foot **Qty 06**

09

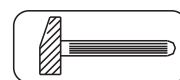
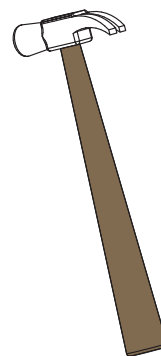
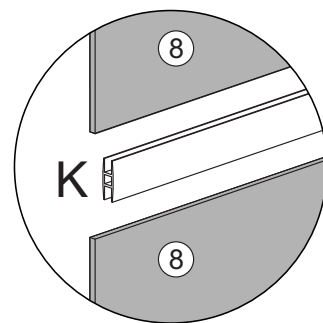
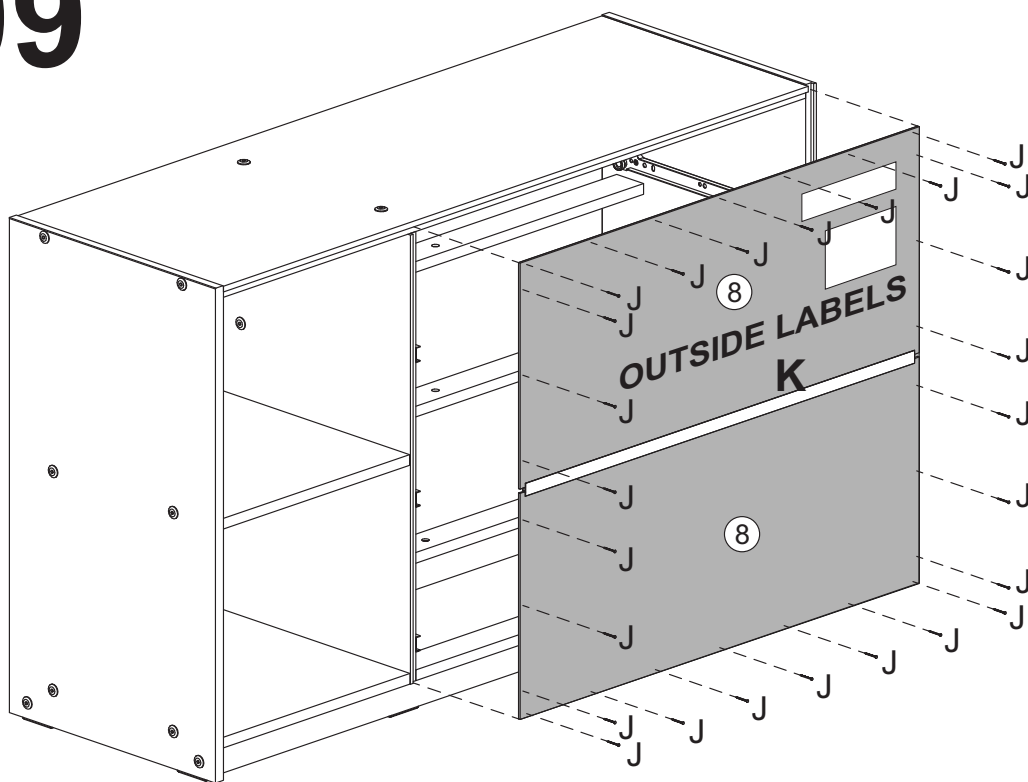

J  10 x 10 **Qty 26**

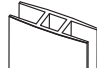
K  **Qty 01**

10

DRAWERS

(x3)

Right

Left

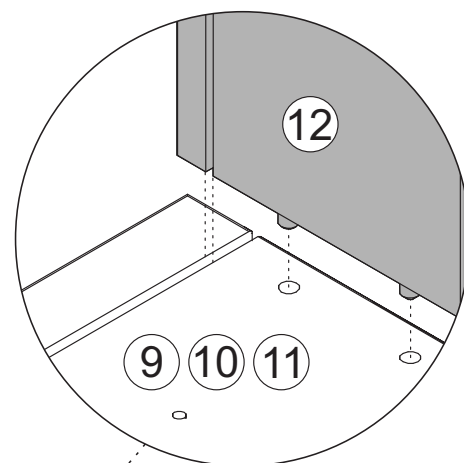
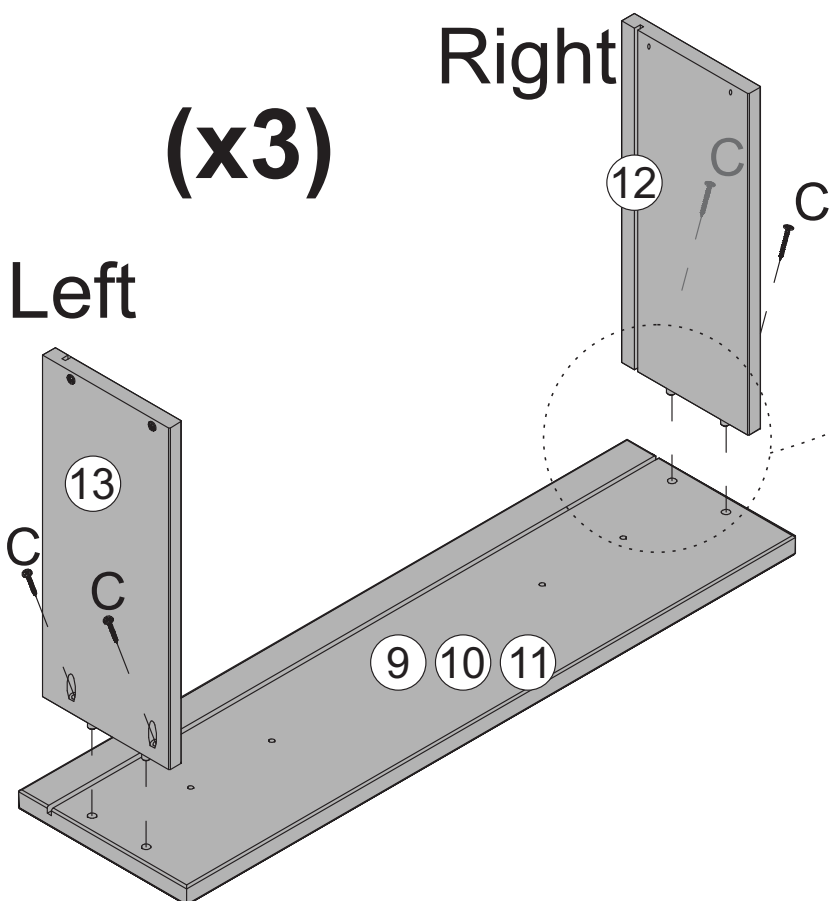

#9 Rustic Dark Grey
#10 Rustic Light Grey
#11 Rustic White

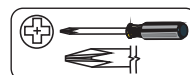

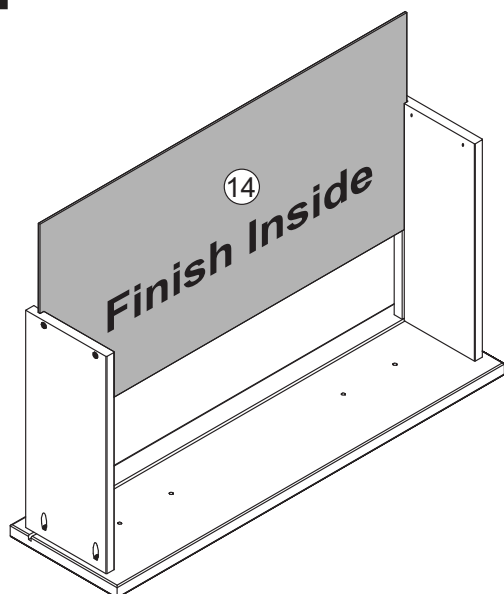

C  4,0 x 30 Screw **Qty 12**

11 (x3)



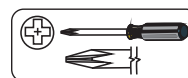
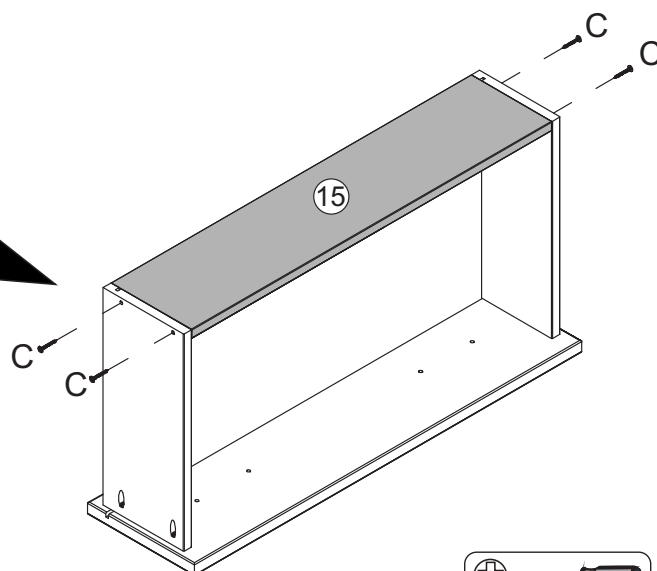

12 (x3)

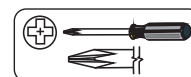
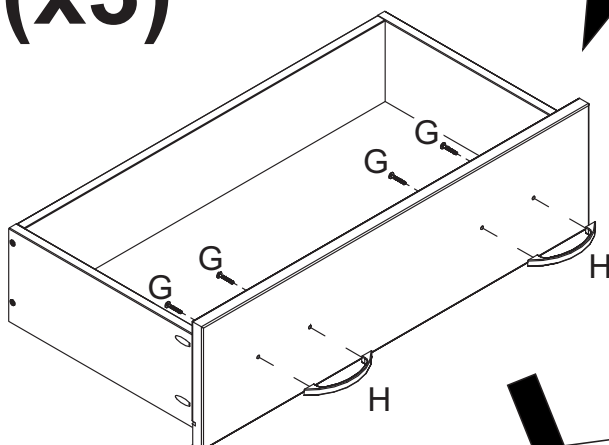

C  **4,0 x 30 Screw** Qty **12**

13 (x3)



G  **M4,0 x 25 Screw** Qty **12**

H  Qty **06**

14 (x3)

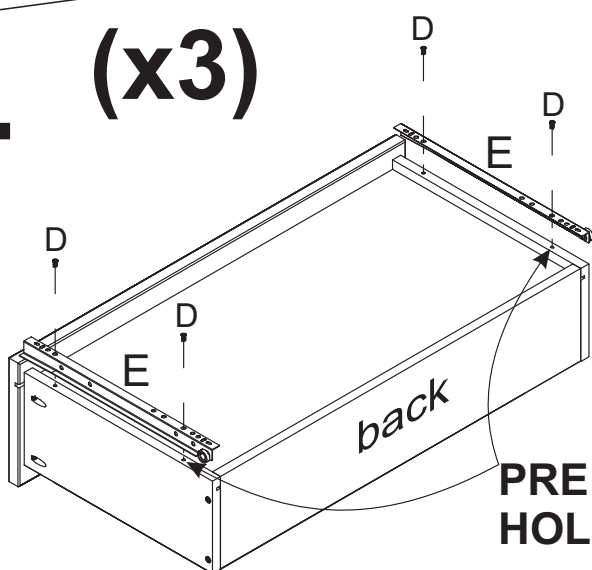

The wheel to the back!

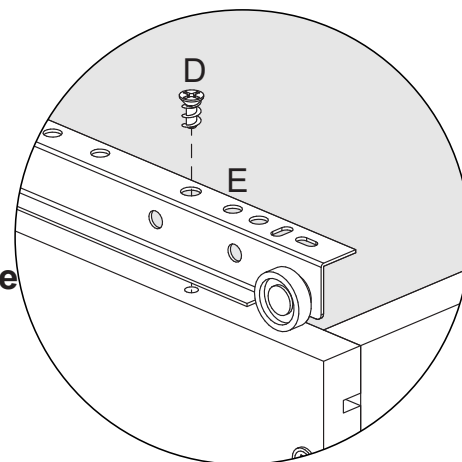

PRE DRILLED HOLES

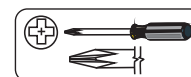

E  **Metal Glides 13 3/4"** Qty **03**

D  **6,0 x 10 Screw** Qty **12**

15

#11 Rustic White

#10 Rustic Ligth Grey

#9 Rustic Dark Grey

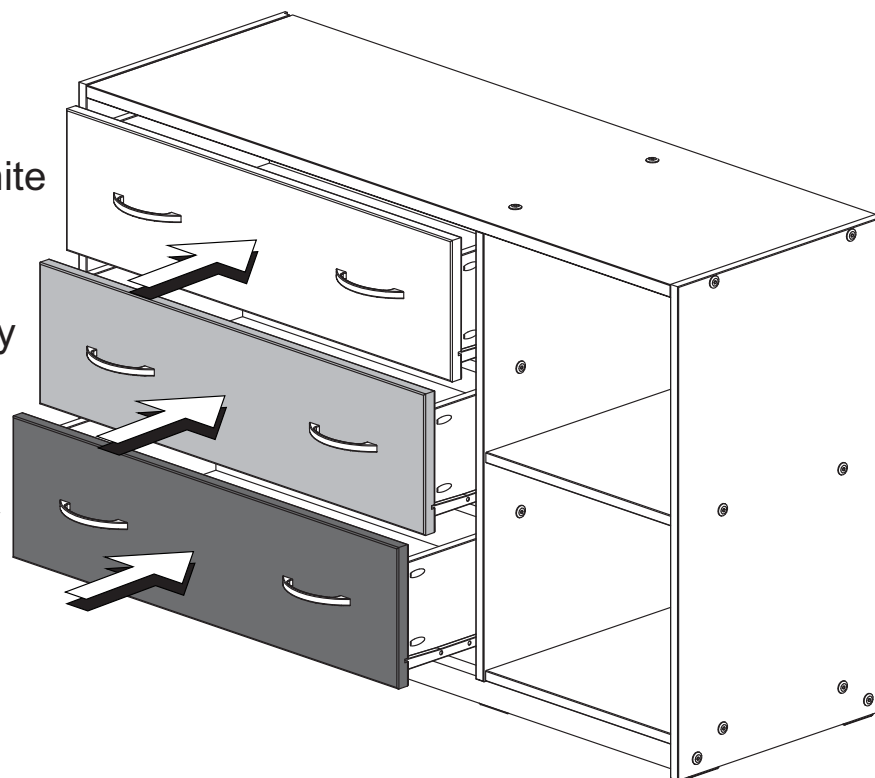

16

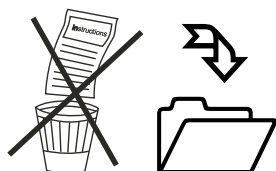
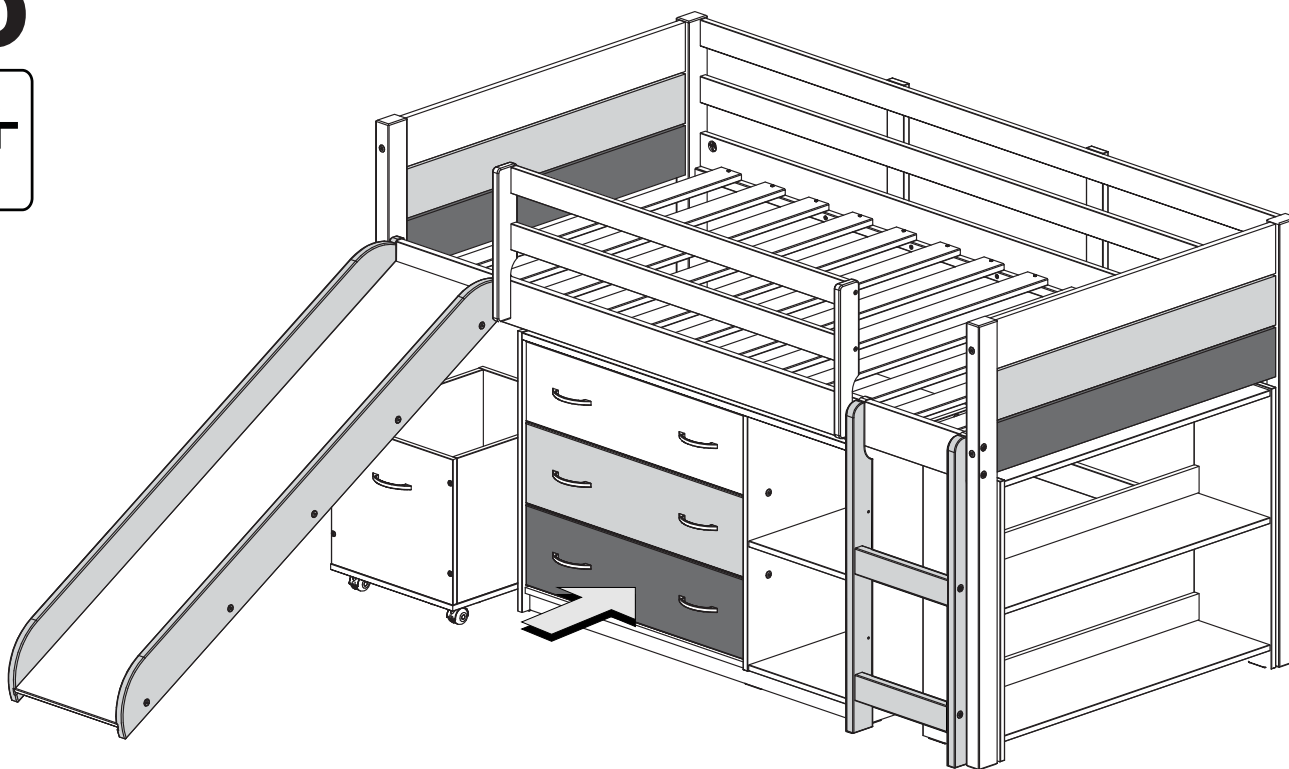
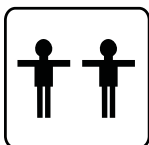

! WARNING

Serious or fatal crushing injuries can occur from furniture tip over. To help prevent tip over:





- * Place heaviest items in the lowest drawers.
- * Unless specifically designed to accommodate do not set TV's or other heavy objects on top of this product.
- * Never allow children to climb or hang on drawers, doors, or shelves.
- * Never open more than one drawer at a time.

Use of tip-over restraints may only reduce, but not eliminate, the risk of tip over.

STEP 01

Tipping restraint Instructions

TIPPING RESTRAINT HARDWARE

W		01
	• nylon strap	
X		01
	• 2" screw	
Y		02
	• wall brackets	
Z		01
	• 5/8" small screw	

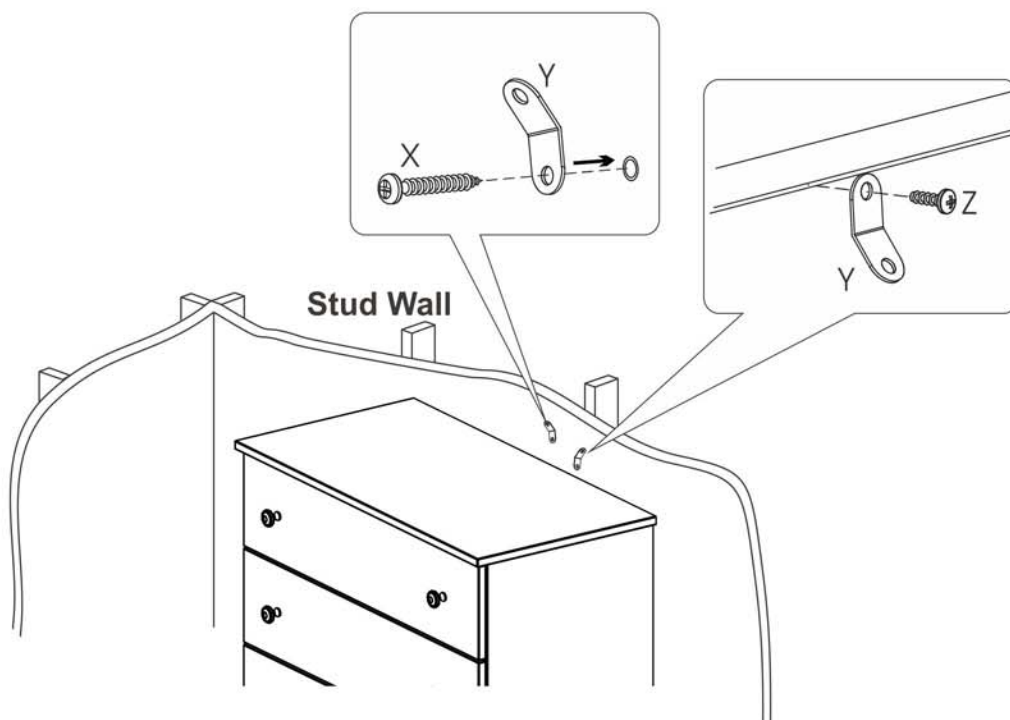

- This tip restraint must be attached to a WALL STUD using the 2" screw enclosed.
- When properly installed, this hardware can provide protection against the unexpected tipping of furniture.
- Attach one of the mounting brackets "Y" securely to the back top edge of the unit using the short screw "Z".
- Locate the other bracket on the wall over a wall stud and 2 inches below the mounting bracket secured to the back of your unit. Attach so the wall stud using the 2" screw provided, through the bracket hole.
- Place the unit so the bracket on the back edge of unit is in line with the bracket on the wall.

STEP 02

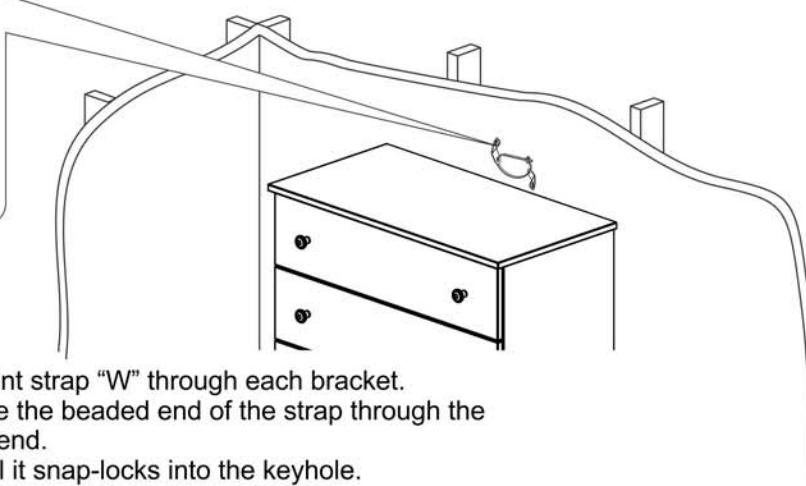
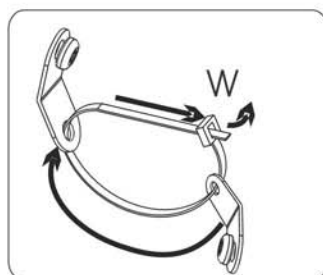

- Lace the end of the nylon restraint strap "W" through each bracket. Bring both ends together and slide the beaded end of the strap through the keyhole shaped slot on the other end. Pull down on the beaded end until it snap-locks into the keyhole.
- Check to make sure the strap is securely laced and locked to the brackets.